

Montering og justering af Tip-on til låger

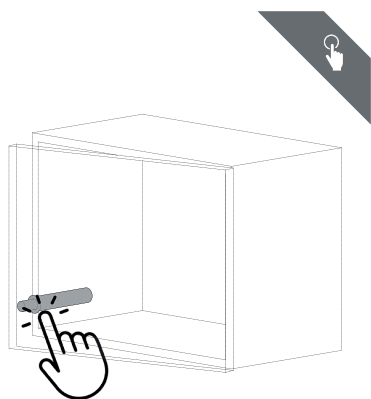

Montering Tip-on til låger

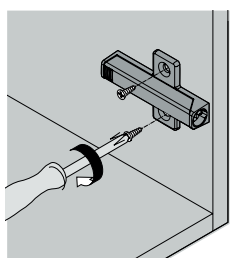

Monter Adapterpladen

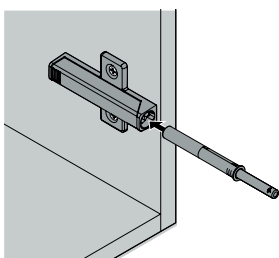

Sæt udløserpinden i.

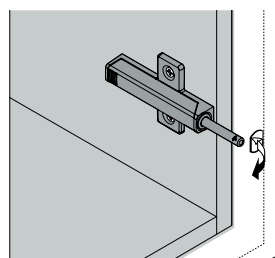

Lim pladen på døren

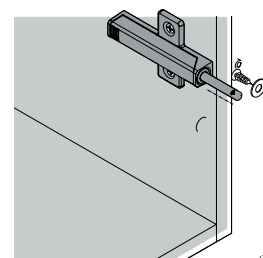

Justering af Tip-on til låger

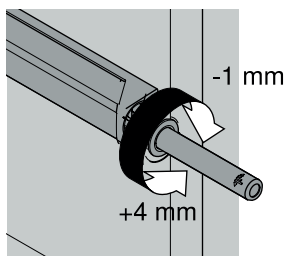

Juster +4 til -1 mm

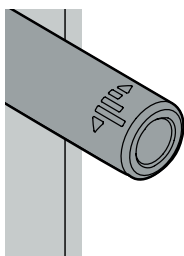

Mærkning i hvilken retning stiften skal drejes

Tip-on kan justeres med den integrerede justerings funktionen (4 til -1 mm).

Mærkningen på Tip-On udløserpinden fortæller dig i hvilken retning stiften skal drejes.